



**17 Highbury Close, Shrewsbury, SY2 6SN**

3 bedroom detached bungalow — £425,000 Freehold

# 17 Highbury Close, Shrewsbury, SY2 6SN

Coopergreenpooks.co.uk

£425,000 Freehold — 3 bedroom detached bungalow

sales@cgpooks.co.uk

This very spacious detached bungalow offers well maintained and improved accommodation, whilst being located in a superb end of cul de sac position with a fantastic rear garden.

## KEY FEATURES

- Entrance vestibule with cloakroom and a sizable hallway.
- Large living room that connects to a separate dining room which also opens to the kitchen.
- Good sized kitchen/breakfast room which is well fitted and has windows to two elevations as well as a part glazed door to the rear patio and garden.
- Three double bedrooms (all with built in wardrobes) and a bathroom with separate shower.
- uPVC double glazed windows and gas fired central heating.
- Driveway providing parking as well as access to the detached garage.
- Lovely private rear garden which has been attractively landscaped to lawn with established borders, paved sun terrace and a wooded border to the rear.
- Well situated at the end of a quiet and private cul de sac in a popular area of the town, yet with easy reach of local shops, the by-pass, retail park and town centre.
- No onward chain.

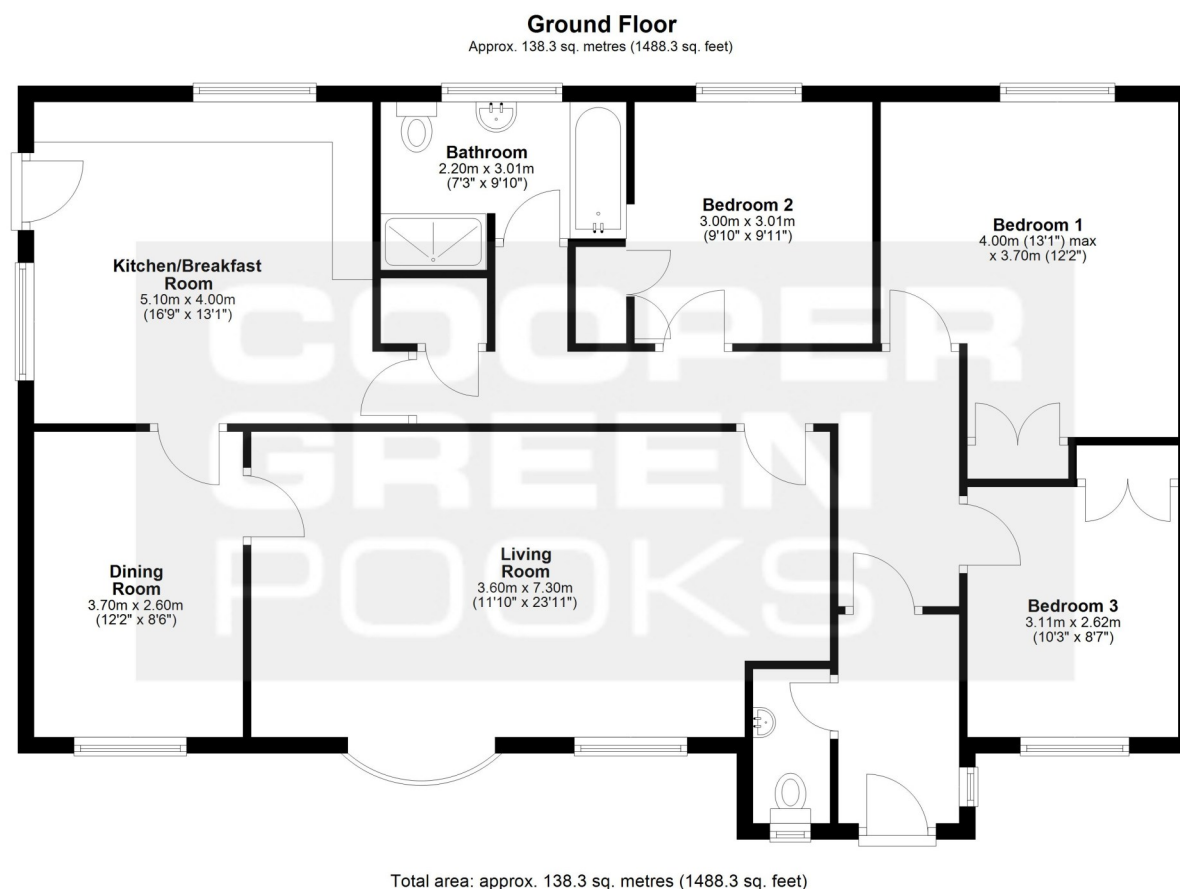







# 17 Highbury Close, Shrewsbury, SY2 6SN

£425,000 Freehold — 3 bedroom detached bungalow

sales@cgpooks.co.uk

rightmove 

 OnTheMarket.com

 **RICS**  
Regulated by RICS

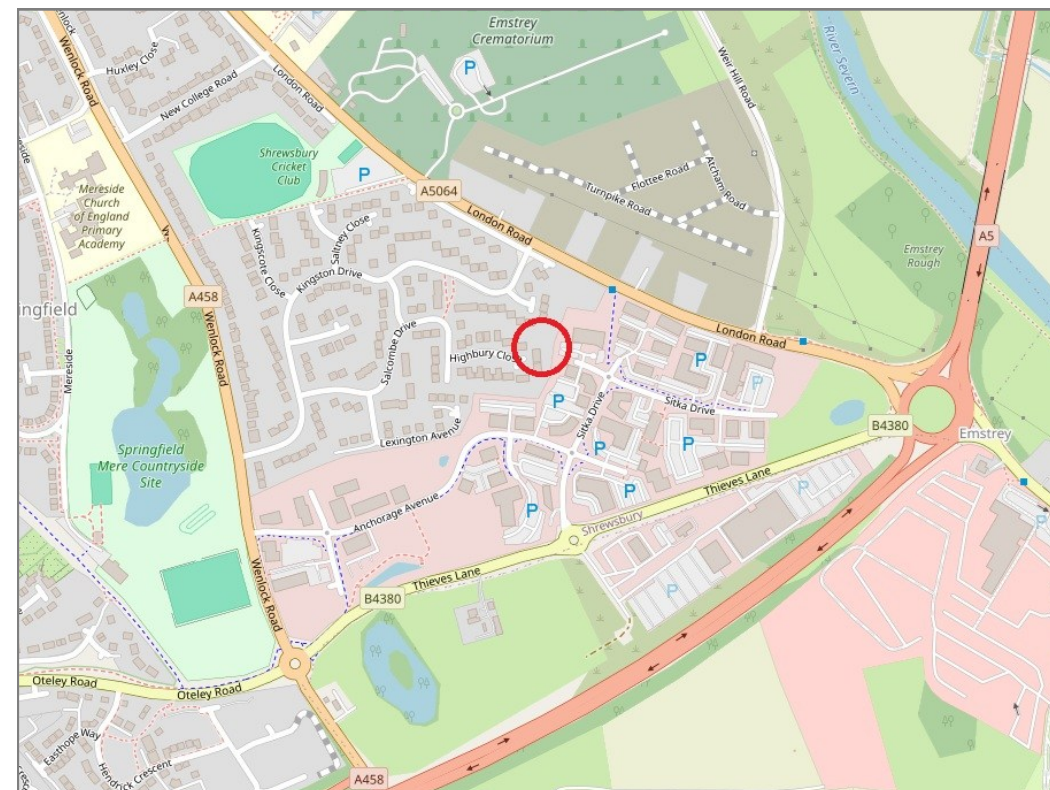

**BOUNDARIES NOT CONFIRMED**

Tenure	<b>Freehold</b>
Local Authority	<b>Shropshire Council</b>
Council Tax	<b>Band D</b>
EPC Band	<b>Band C</b>
Services	<b>All mains services are connected</b>

 **Expert mortgage advice available**

3 Barker St, Shrewsbury SY1 1QF

**Cooper Green Pooks**  
**01743 276666**



Your home may be repossessed if you do not keep up repayments on your mortgage.

There may be a fee for mortgage advice. The actual amount you pay will depend upon your circumstances. The fee is up to 1% but a typical fee is 0.3% of the amount borrowed.

# 17 Highbury Close, Shrewsbury, SY2 6SN

Coopergreenpooks.co.uk

£425,000 Freehold — 3 bedroom detached bungalow

sales@cgpooks.co.uk

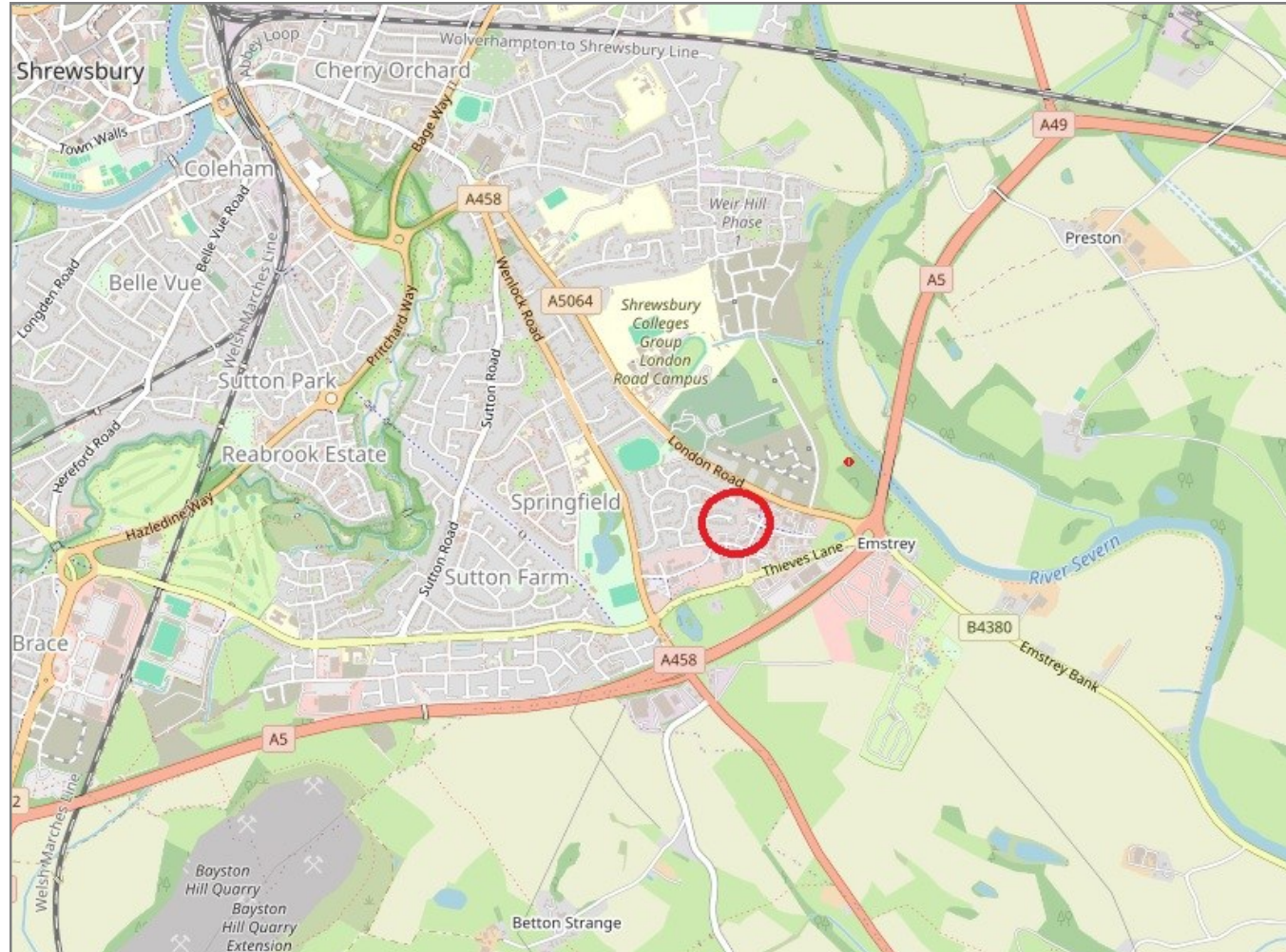

**IMPORTANT NOTICE:** Cooper Green Pooks for themselves and for the lessors or vendors of this property whose agents they are give notice that: 1 No appliances, services or service installations have been tested and no warranty as to suitability or serviceability is implied. Any prospective purchaser or lessee is advised to obtain verification from their surveyor or solicitor. 2. The particulars are set out as a general outline only for the guidance of the intended purchasers or lessees and do not constitute, nor constitute part of, an offer or contract. 3. All descriptions, reference to condition and necessary permissions for use and occupation and other details are given in good faith and are believed to be correct but any intending purchasers or lessees should not rely on them as statements or representation of fact but satisfy themselves by inspection or otherwise as to the correctness of each of them. 4. No person in the employment of Cooper Green Pooks has any authority to make or give any representation or warranty whatsoever in relation to this property. 5. All rentals and prices are quoted exclusive of Stamp Duty, legal and surveyors fees and any other associated purchasers or lessees costs. 6. Floor plans are indicative only and should not be relied on. 7. The plan showing the boundary of the property is indicative only and has not been checked against the legal title so should not be relied on. 8. All dimensions, floor areas and site areas are only approximate and should not be relied on. Dimensions are generally maximum room dimension.